

# SOUTH BEND AREA MAP

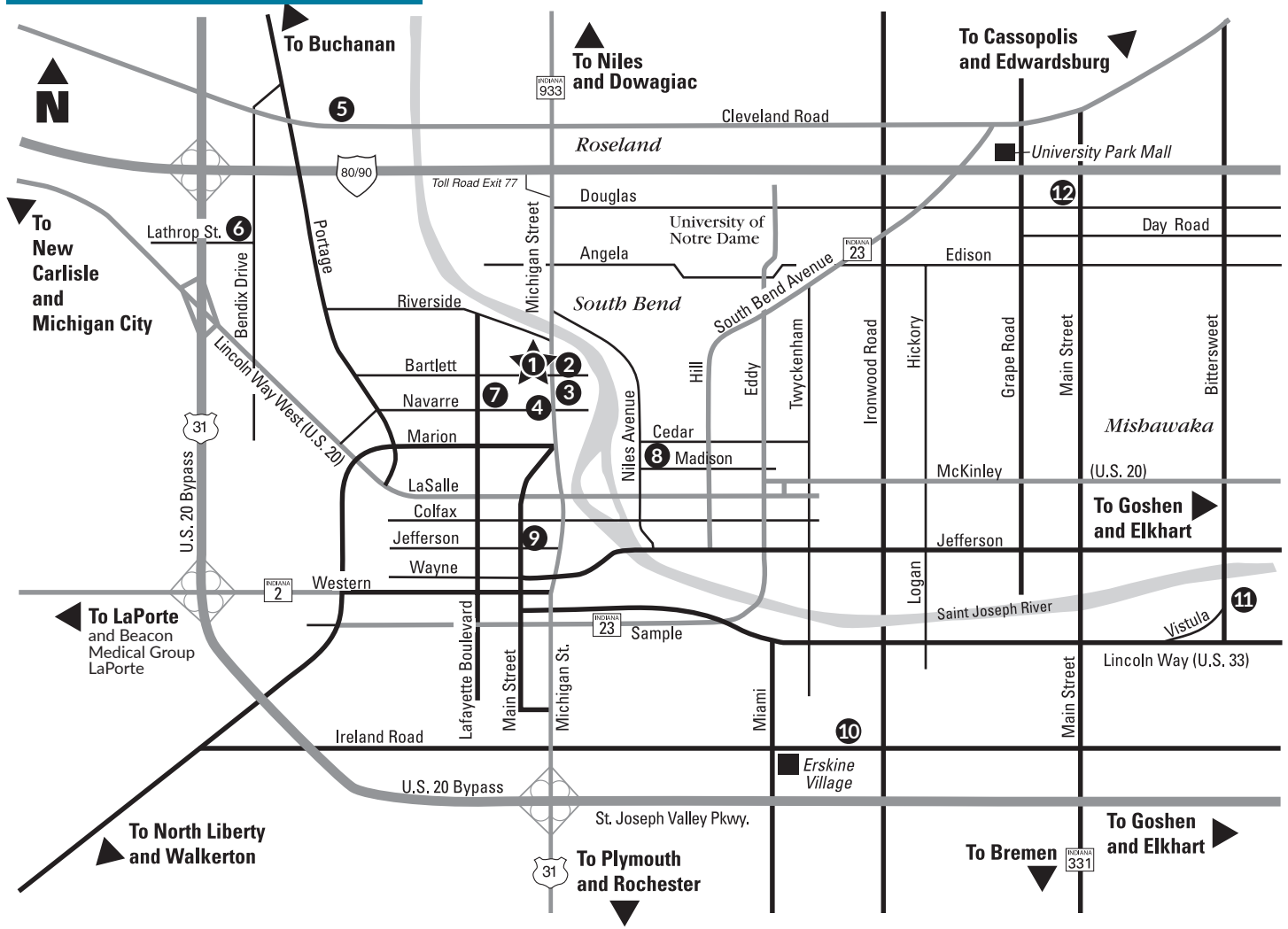

- |  |  |
|--|--|
| <p>1. 615 N. Michigan St.<br/> <b>Memorial Hospital of South Bend</b><br/> <b>Beacon Children's Hospital</b><br/> <b>Memorial Leighton Heart &amp; Vascular Center</b><br/> <b>Beacon Cancer Care</b><br/> <b>Beacon Medical Group Physical Medicine &amp; Rehabilitation</b><br/>           Centennial Medical Square, 621 Memorial Dr.<br/> <b>Beacon Medical Group Midwifery Centered Care, Ste. 403</b><br/> <b>Beacon Medical Group Trauma &amp; Surgical Services, Ste. 502</b><br/> <b>Memorial Pain Control Center, Ste. 617</b><br/>           Memorial Medical Plaza, 707 N. Michigan St.<br/> <b>Anticoagulation Clinic, Ste. 115</b><br/> <b>Beacon Medical Group Behavioral Health, Ste. 400</b><br/> <b>Beacon Medical Group Neurology, Ste. 102</b><br/> <b>Memorial Sleep Disorders Center, Ste. 500</b></p> <p>2. Beacon Medical Group E. Blair Warner<br/> <b>Memorial Family Medicine Residency, 714 N. Michigan St.</b></p> <p>3. Skyway Building, 610 N. Michigan St.<br/> <b>Beacon Medical Group Cardiothoracic Surgery, Ste. 306</b><br/> <b>Beacon Medical Group Advanced Cardiovascular Specialists, Ste. 400</b></p> <p>4. 100 Navarre Place<br/> <b>Beacon Medical Group Gastroenterology South Bend, Ste. 4400</b><br/> <b>Beacon Medical Group Gynecologic Oncology, Ste. 4470</b><br/> <b>Beacon Bone &amp; Joint Specialists, Ste. 4440</b><br/> <b>Beacon Medical Group ENT &amp; Audiology, Ste. 4460</b><br/> <b>Beacon Medical Group Pediatric Multispecialty, Ste. 5550</b><br/> <b>Beacon Medical Group Neurosurgery South Bend, Ste. 6600</b><br/> <b>Beacon Medical Group Interventional Radiology &amp; Vascular Specialists, Ste. 5500</b><br/> <b>Memorial Children's Therapy Center, Ste. 6650</b><br/> <b>Memorial Regional Breast Care Center, Ste. 6655</b><br/> <b>Navarre Radiology, EEG/EMG, Ste. 5510</b></p> | <p>5. <b>Beacon Medical Group Cleveland Road</b><br/>           2235 Cleveland Rd.</p> <p>6. <b>Beacon Occupational Health South Bend</b><br/>           2301 N. Bendix Dr.</p> <p>7. <b>Labcorp</b><br/>           530 N. Lafayette Blvd.</p> <p>8. <b>Memorial Epworth Center</b><br/>           420 N. Niles Ave.</p> <p>9. Leighton HealthPlex, 111 W. Jefferson Blvd.<br/> <b>Beacon Bone &amp; Joint Specialists, 1st floor</b><br/> <b>Memorial Outpatient Therapy Services, 1st floor</b><br/> <b>Beacon Health &amp; Fitness South Bend, 3rd floor</b></p> <p>10. <b>Beacon Medical Group Ireland Road &amp; MedPoint Urgent Care</b><br/>           1815 Ireland Rd.</p> <p>11. <b>Beacon Medical Group Schwartz-Wiekamp</b><br/>           4630 Vistula Rd., Mishawaka</p> <p>12. <b>Beacon Medical Group Main Street &amp; MedPoint Urgent Care,</b><br/>           6913 N. Main St., Granger<br/> <b>Beacon Medical Group Specialists, Ste. 100</b><br/> <b>Beacon Medical Group Rheumatology, Ste. 102</b><br/> <b>Beacon Medical Group Pediatrics Main Street, Ste. 200</b><br/>           6901 N. Main St., Granger<br/> <b>Memorial Lighthouse Imaging Center</b></p> |
|--|--|





Memorial Hospital Police Department and Security provide vehicle escorts to and from the surface lots 24/7. Please call Security Dispatch at 574.647.3245.

- Hospital Buildings
- Parking Garages
- Visitor & Patient Parking
- Staff Parking

**Patient Information:**

Floor \_\_\_\_\_ Room \_\_\_\_\_ Phone 574.647. \_\_\_\_\_

Patient Information: 574.647.7219



**ELEVATOR GUIDE**

*Certain areas of the Hospital can only be accessed through certain Elevators*

**ELEVATOR A**  
 Centennial Medical Square  
 Offices floors 3 to 6  
 Surgical Discharge 2nd floor  
 Childbirth Unit 3rd floor

**ELEVATOR B**  
 Floors 1 to 8

**ELEVATOR C**  
 Floors 1 to 12  
 • DOES NOT STOP on 4

**ELEVATOR E**  
 Emergency Room 2nd floor  
 Childbirth Unit 3rd floor  
 Pediatric Hem/Onc 4th floor

**ELEVATOR H**  
 Heart and Vascular Center:  
 Short Stay 2nd floor  
 ICU 3rd floor



**FIRST FLOOR**

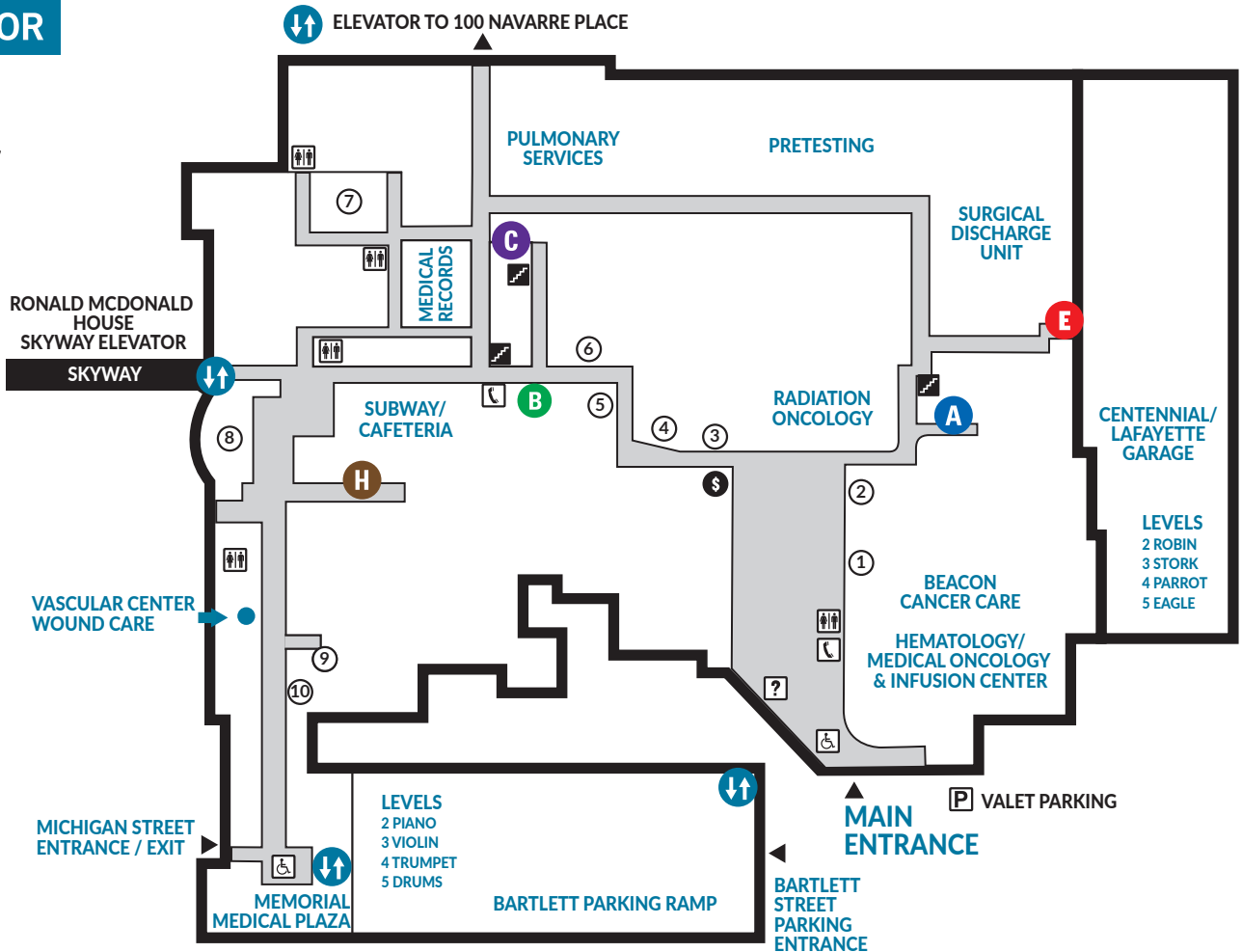
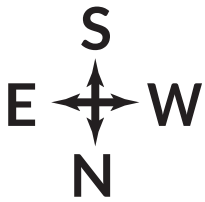

- 1. Starbucks
- 2. Main Admitting
- 3. Cashier
- 4. Cottage Place Gift Shop
- 5. Flower Shop

- 6. Pastoral & Social Services
- 7. Auditorium
- 8. Memorial Interfaith Chapel
- 9. Memorial Masjid
- 10. Anti-Coagulation

**Valet information:**  
 \$15  
 Mon - Fri: 5 a.m. - 9 p.m.  
 Weekend: 7 a.m. - 7 p.m.

**SECOND FLOOR**

1. Radiology Check-in
2. Cardiac Diagnostic Area
3. Pantry Place (24-hour self-service meals and snacks)
4. Short Stay Cath Lab; Interventional Radiology

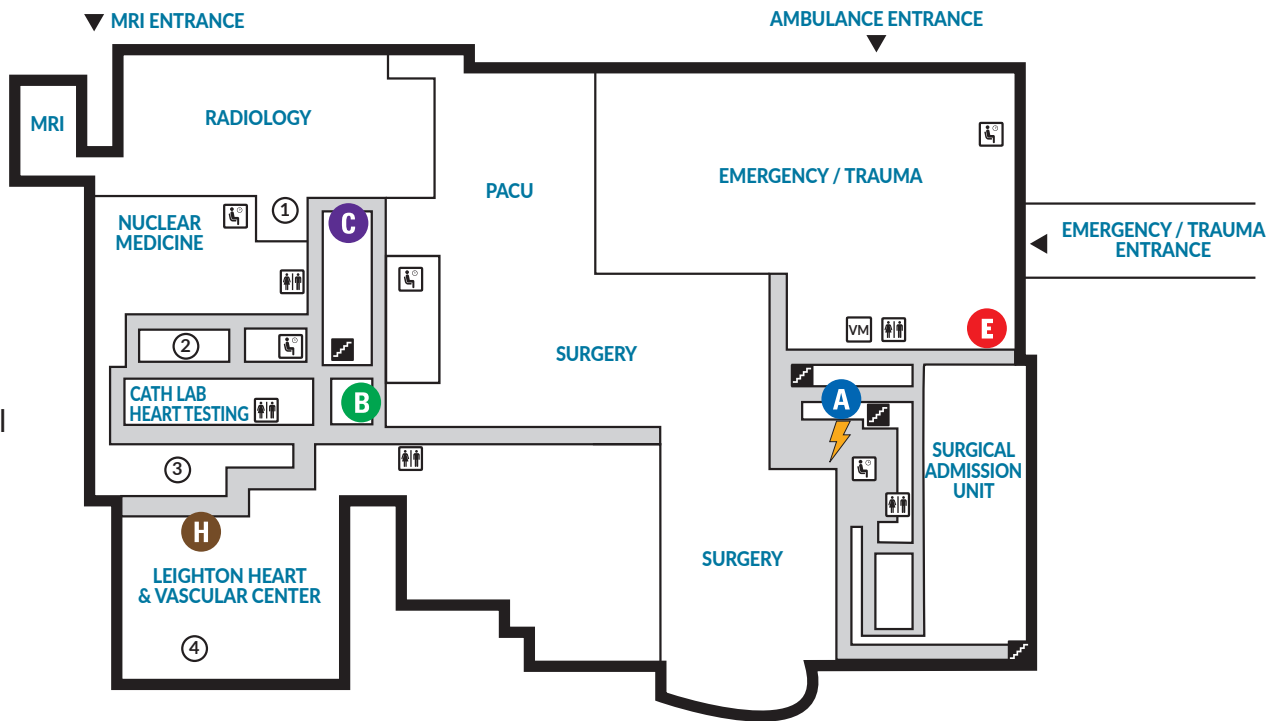
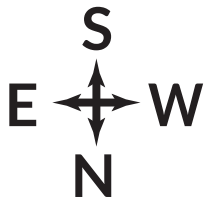

**THIRD FLOOR**

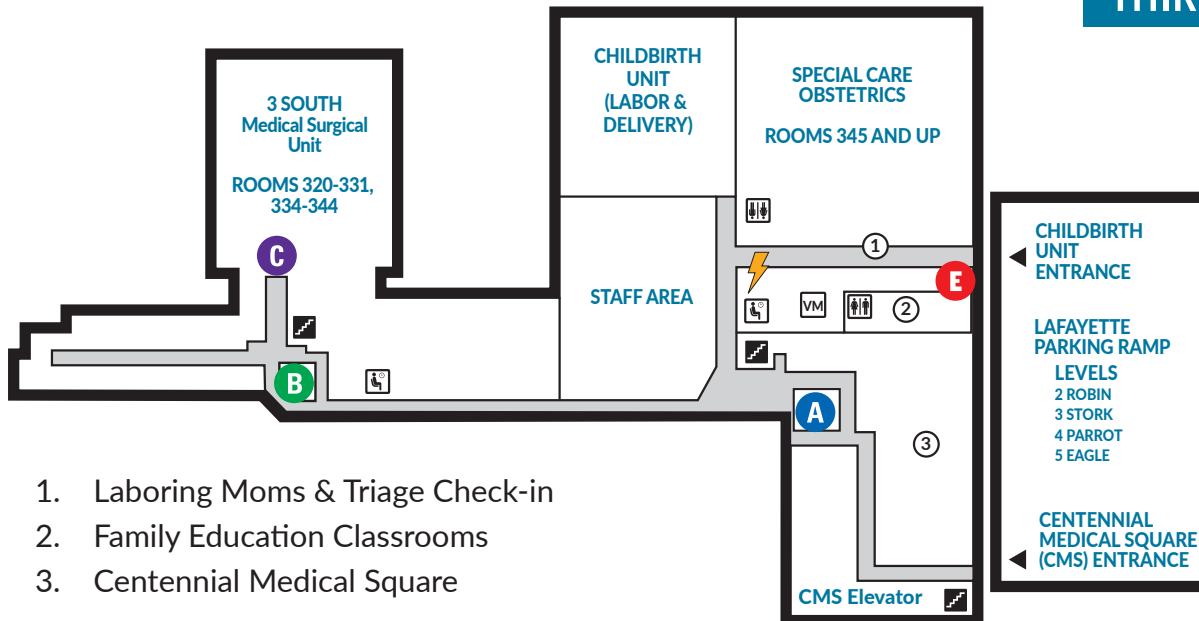

**LEGEND**

- |              |                |                  |                       |
|--------------|----------------|------------------|-----------------------|
| INFORMATION  | STAIRS         | ATM              | WHEELCHAIRS AVAILABLE |
| WAITING ROOM | COURTESY PHONE | RESTROOMS        | VENDING MACHINES      |
|              |                | CHARGING STATION |                       |