

# SOUTH BEND AREA MAP

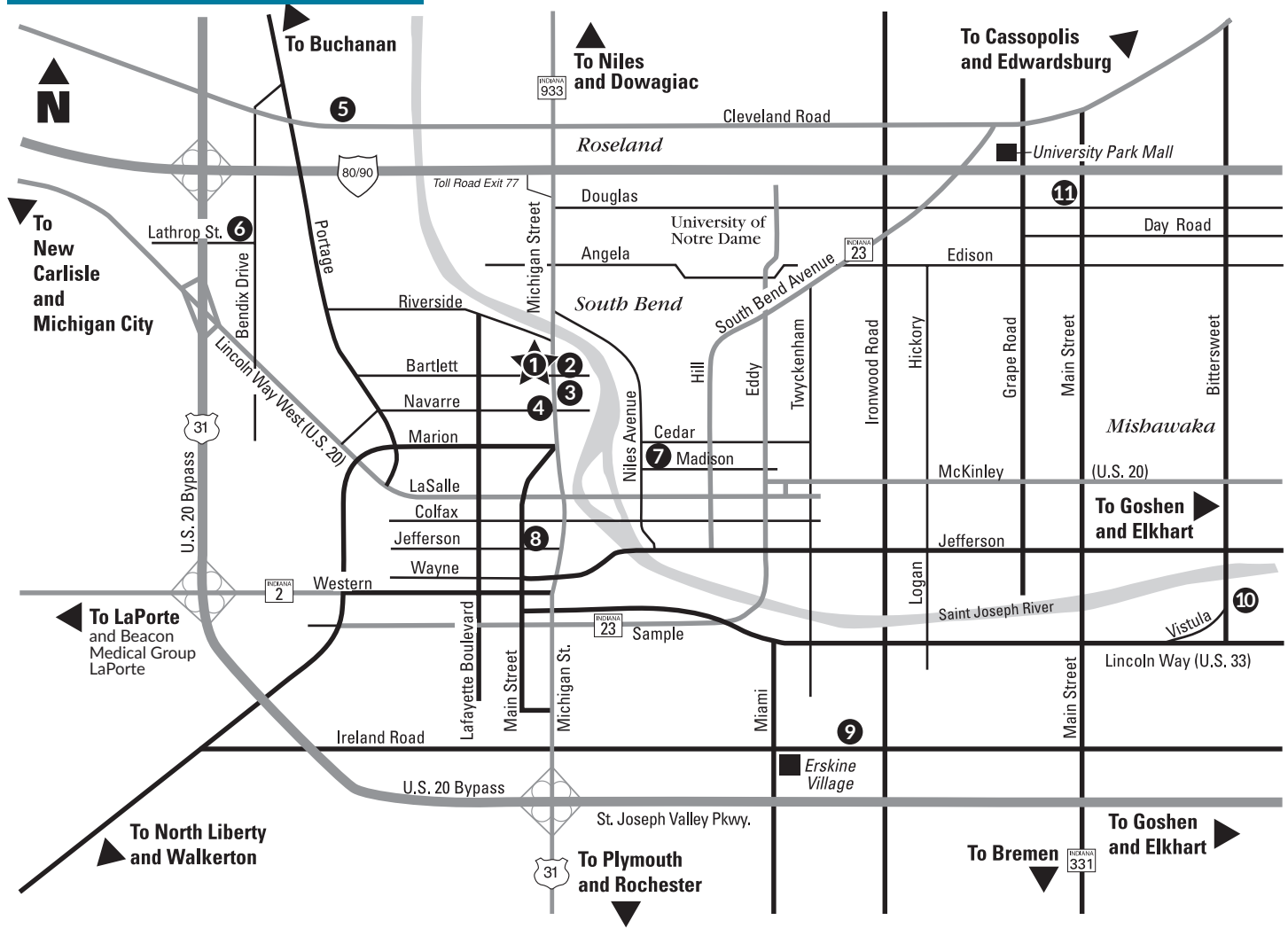

1. 615 N. Michigan St.  
**Memorial Hospital of South Bend**  
**Beacon Children's Hospital**  
**Memorial Leighton Heart & Vascular Center**  
**Beacon Cancer Care**  
**Beacon Medical Group Oncology South Bend**  
**Beacon Medical Group Physical Medicine & Rehabilitation**  
 Centennial Medical Square, 621 Memorial Dr.  
**Beacon Medical Group Trauma & Surgical Services, Ste. 502**  
**Memorial Pain Control Center, Ste. 617**  
 Memorial Medical Plaza, 707 N. Michigan St.  
**Anticoagulation Clinic, Ste. 115**  
**Beacon Medical Group Behavioral Health, Ste. 400**  
**Memorial Sleep Disorders Center, Ste. 500**
2. Beacon Medical Group E. Blair Warner  
**Memorial Family Medicine Residency, 714 N. Michigan St.**
3. Skyway Building, 610 N. Michigan St.  
**Beacon Medical Group Cardiothoracic Surgery, Ste. 306**  
**Beacon Medical Group Advanced Cardiovascular Specialists, Ste. 400**
4. 100 Navarre Place  
**Beacon Medical Group Gastroenterology South Bend, Ste. 4400**  
**Beacon Medical Group Midwifery Centered Care, Ste. 4470**  
**Beacon Bone & Joint Specialists, Ste. 4440**  
**Beacon Medical Group ENT & Audiology, Ste. 4460**  
**Beacon Medical Group Pediatric Multispecialty, Ste. 5550**  
**Beacon Medical Group Neurosurgery South Bend, Ste. 6600**  
**Beacon Medical Group Interventional Radiology & Vascular Specialists, Ste. 5500**  
**Memorial Children's Therapy Center, Ste. 6650**  
**Memorial Regional Breast Care Center, Ste. 6655**  
**Navarre Radiology, EEG/EMG, Ste. 5510**
5. **Beacon Medical Group Cleveland Road**  
 2235 Cleveland Rd.
6. **Beacon Occupational Health South Bend**  
 2301 N. Bendix Dr.
7. **Memorial Epworth Center**  
 420 N. Niles Ave.
8. Leighton HealthPlex, 111 W. Jefferson Blvd.  
**Beacon Bone & Joint Specialists, 1st floor**  
**Memorial Outpatient Therapy Services, 1st floor**
9. **Beacon Medical Group Ireland Road & MedPoint Urgent Care**  
 1815 Ireland Rd.
10. **Beacon Medical Group Schwartz-Wiekamp**  
 4630 Vistula Rd., Mishawaka
11. Beacon Medical Group Main Street & MedPoint Urgent Care, 6913 N. Main St., Granger  
**Beacon Medical Group Neurology South Bend, Ste. 100**  
**Beacon Medical Group Rheumatology, Ste. 102**  
**Beacon Medical Group Pediatrics Main Street, Ste. 200**  
**Beacon Medical Group Specialists, Ste. 200**  
 6901 N. Main St., Granger  
**Memorial Lighthouse Imaging Center**





Memorial Hospital Police Department and Security provide vehicle escorts to and from the surface lots 24/7. Please call Security Dispatch at 574.647.3245.

- Hospital Buildings
- Parking Garages
- Visitor & Patient Parking
- Staff Parking

**Patient Information:**

Floor \_\_\_\_\_ Room \_\_\_\_\_ Phone 574.647. \_\_\_\_\_

Patient Information: 574.647.7219



**ELEVATOR GUIDE** *Certain areas of the Hospital can only be accessed through certain Elevators*

**ELEVATOR A**  
 Centennial Medical Square  
 Offices floors 3 to 6  
 Surgical Discharge 2nd floor  
 Childbirth Unit 3rd floor

**ELEVATOR B**  
 Floors 1 to 8

**ELEVATOR C**  
 Floors 1 to 12  
 • DOES NOT STOP on 4

**ELEVATOR E**  
 Emergency Room 2nd floor  
 Childbirth Unit 3rd floor  
 Pediatric Hem/Onc 4th floor

**ELEVATOR H**  
 Heart and Vascular Center:  
 Short Stay 2nd floor  
 ICU 3rd floor



**FIRST FLOOR**

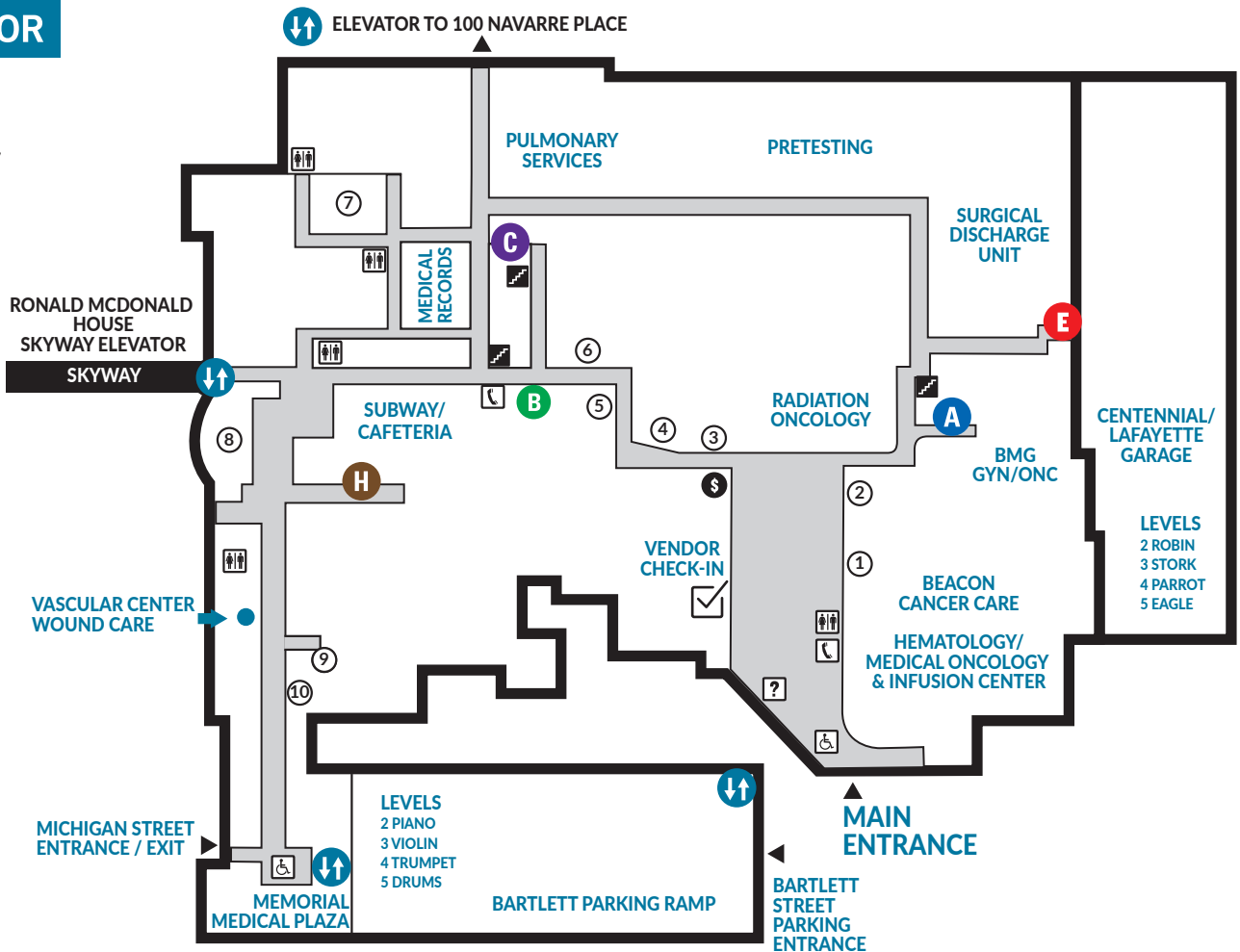
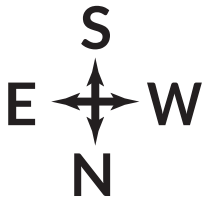

- |                            |                               |
|----------------------------|-------------------------------|
| 1. Starbucks               | 6. Pastoral & Social Services |
| 2. Main Admitting          | 7. Auditorium                 |
| 3. Cashier                 | 8. Memorial Interfaith Chapel |
| 4. Cottage Place Gift Shop | 9. Memorial Masjid            |
| 5. Flower Shop             | 10. Anti-Coagulation          |

SECOND FLOOR

1. Radiology Check-in
2. Cardiac Diagnostic Area
3. Pantry Place (24-hour self-service meals and snacks)
4. Short Stay Cath Lab; Interventional Radiology

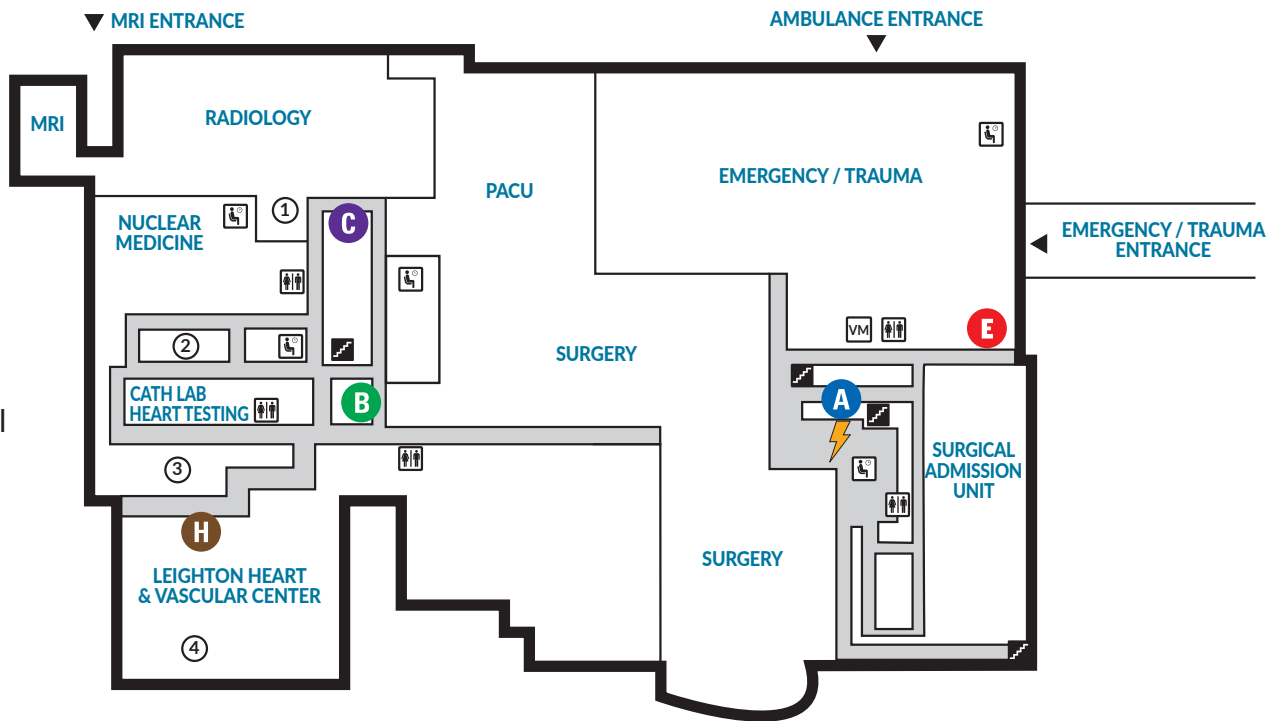
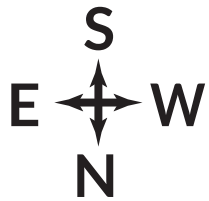

THIRD FLOOR

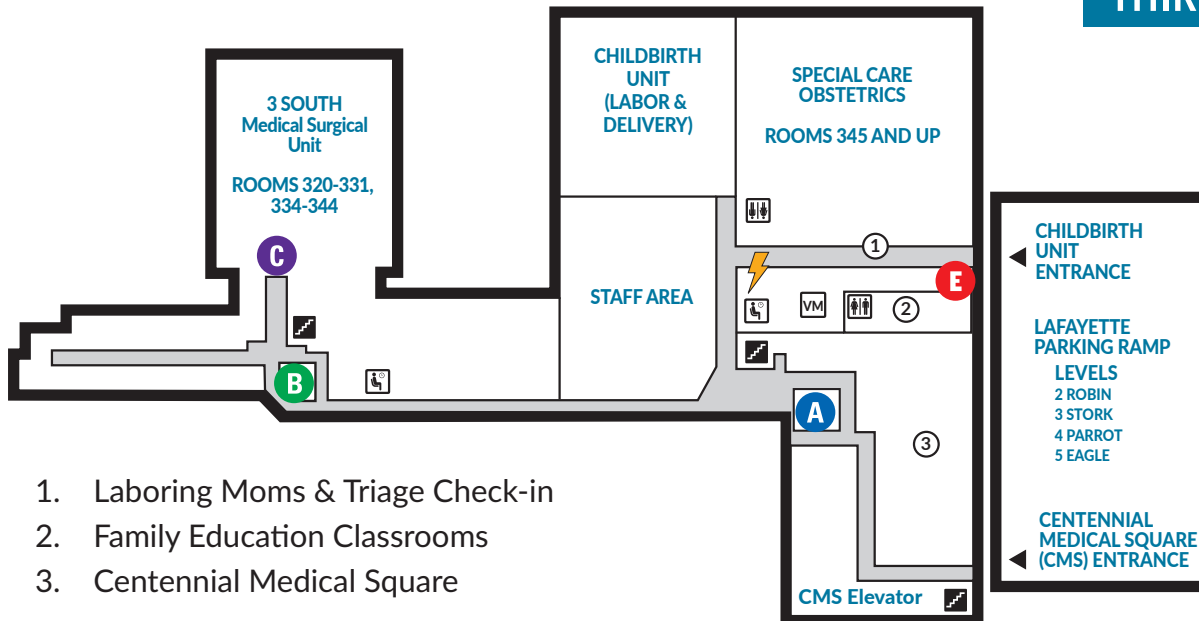

LEGEND

- |              |                |                  |                       |
|--------------|----------------|------------------|-----------------------|
| INFORMATION  | STAIRS         | ATM              | WHEELCHAIRS AVAILABLE |
| WAITING ROOM | COURTESY PHONE | RESTROOMS        | VENDING MACHINES      |
|              |                | CHARGING STATION |                       |